

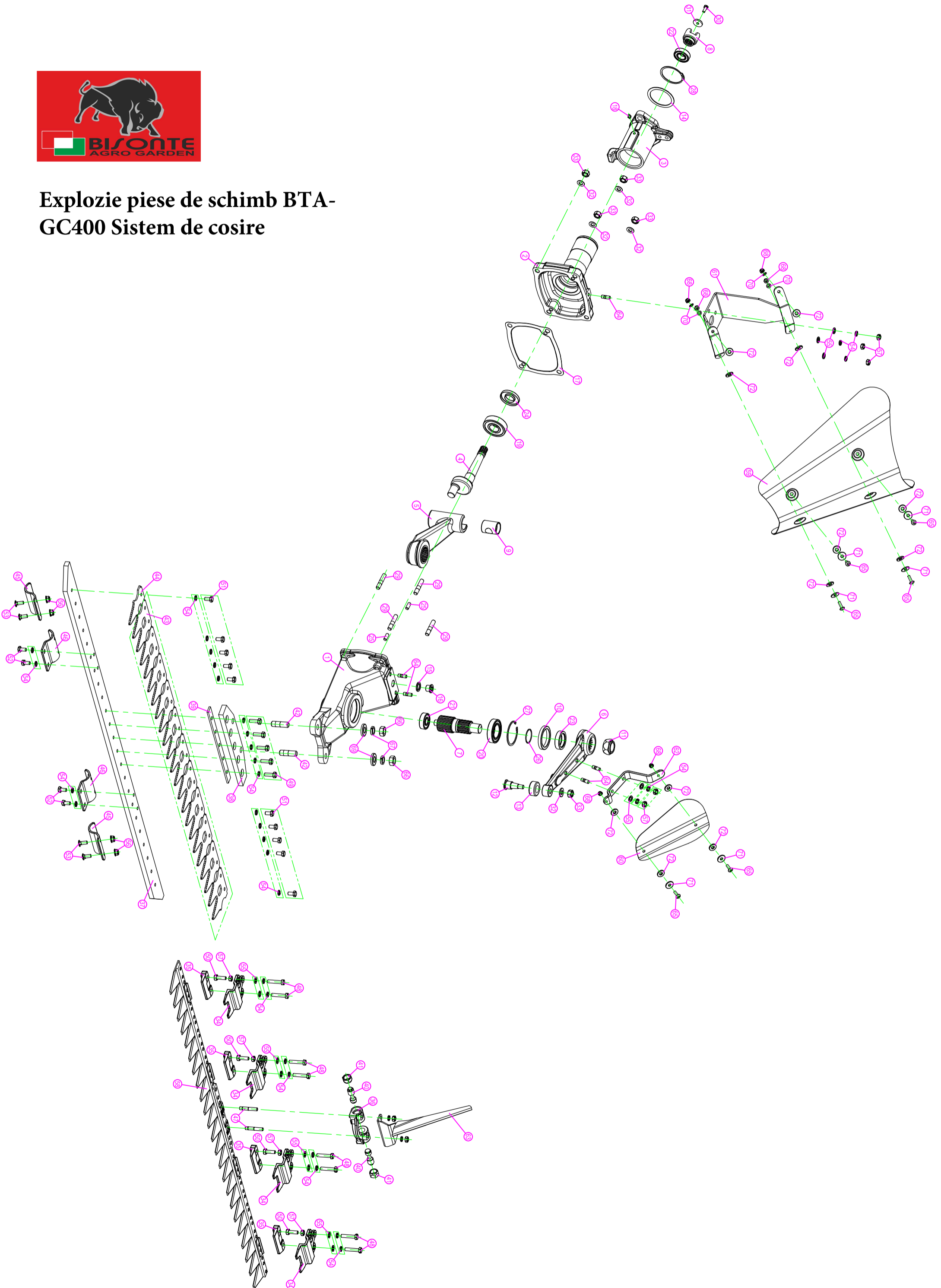

Explozie piese de schimb BTA- GC400 Sistem de cosire



1	HT250	GC400.01-01	1	201815001	1	
2	QT450-10	GC400.01-02	1	201815002	2	
3	HT250	GC400.01-03	1	201815003	3	
4	20CrMnTi	GC400.01-04	1	201815004	4	
5	40Cr	GC400.01-05	1	201815005	5	
6	40Cr	GC400.01-06	1	201815006	6	
7	20CrMnTi	GC400.01-07	1	201815007	7	
8	20CrMnTi	GC400.01-08	1	201815008	8	
9	20CrMnTi	GC400.01-09	1	201815009	9	
10	20CrMnTi	GC400.01-10	1	201815010	10	
11	45#	GC400.01-11	1	201815011	11	
12	20CrMnTi	GC400.01-12	1	201815012	12	
13	20CrMnTi	GC400.01-13	1	201815013	13	
14	65Mn	GC400.01-14	1	201815014	14	
15	D23×d16.2×3	ZHXJ-01	1	201102022	15	
16	M16×1.5×12	XZJ.01-12	1	201102021	16	
17		GC400.01-16	1	201815016	17	
18	M6		1	201102095	18	
19	D62×d25×17	GB/T276-1994	1	G08116HRB	19	
20	D62×d35×14	GB/T276-1994	1	G08121HRB	20	
21	D42×d15×13	GB/T276-1994	1	G08112HRB	21	
22	D42×d20×12	GB/T276-1994	1	G08037HRB	22	
23	D62×d48×8	GB/T9877.1-1988	1	G05045	23	
24	D52×d25×7	GB/T9877.1-1988	1	G05017	24	
25	D8×20	GB/T119.1-2000	2	G11022	25	
26	D3×d2	GB/T3452.1-2005	1	G05055	26	
27	D62×2	GB/T893.1-1986	1	G10014	27	
28	D60×2	GB/T894.1-1986	1	G09022	28	
29	M10×35 (50)	GB/T900-1988 8.8	4	G01428	29	
30	M6×16	GB/T5782-2000	1	G01115H	30	
31	D25×d6.5×4	GB/T5287-2002	1	G02038B	31	
32	D10	GB/T95-2002	5	G02002B	32	
33	M10		5	G04059B	33	
34	40Cr	GC400.02-01	4	201815017	34	
35	40Cr	GC400.02-02	4	201815018	35	
36	40Cr	GC400.02-03	1	201815019	36	
37	Q235-A	GC400.02-04	1	201815020	37	
38	Q235-A	GC400.02-05	1	201815021	38	
39	Q235-A	GC400.02-06	1	201815022	39	
40	40Cr	GC400.02-07	2	201815023	40	
41	45#	GC400.02-08	2	201815024	41	
42	8.8级	GC400.02-09	2	201815025	42	
43	65Mn	XZJ.03.02-02	11	201815026A	43	

44	65Mn	XZJ.03.02-03	1	201815027A	44	blade assy
45	Q235-A	XZJ.03-07	2	201106028	45	
46	Q235-A	XZJ.03-05	2	201106029	46	
47	8.8级	GC400.02-15	2	201815040	47	
48	M8×40	GB/T5782-2000	8	G01003H	48	
49	M8×30	GB/T5782-2000	5	G01045H	49	
50	M8×25	GB/T5782-2000	4	G01004H	50	
51	M8×20	GB/T5782-2000	10	G01005H	51	
52	M8×16	GB/T5782-2000	4	G01006H	52	
53	M8×20	GB/T12-1988	4	G01094H	53	
54	D8	GB/T93-1987	32	G03002H	54	
55	D8	GB/T95-2002	13	G02003B	55	
56	M8	GB/T6183.1-2000	4	G04018B	56	
57	M8	GB/T6170-2000	9	G04002B	57	
58		GC400.02A	1	201815051	58	
66	Q235-A	GC400.00-03	1	201815035	59	
67	Q235-A	XZJ-04	1	201106026	60	
68	Q235-A	GC400.00-07	1	201815038	61	
69	Q235-A	XZJ-03	1	201106004	62	
70	Q235-A	GC400.00-08	1	201815039	63	
71	M8×16 (28)		5	G01103	64	
72	M6×20	GB/T70.2-2008	6	G01017H	65	
74	M14×1.5	GB/T6171-2000	2	G04060B	66	
75	D14	GB/T93-1987	2	G03024H	67	
76	M6	GB/T889.1-2000	6	G04006B	68	
77	D32×d14.5×5	GB/T96.2-2002	2	G02039B	69	
78	D6	GB/T95-2002	4	G02008B	70	
79	D24×d6.3×2	GB/T5287-2002	6	G02007B	71	
80		XZJ-07	12	201106002	72	